



**We hope you enjoyed
your day on the water.**

*If you borrowed a life jacket, please return
it so others can practice safe boating.*





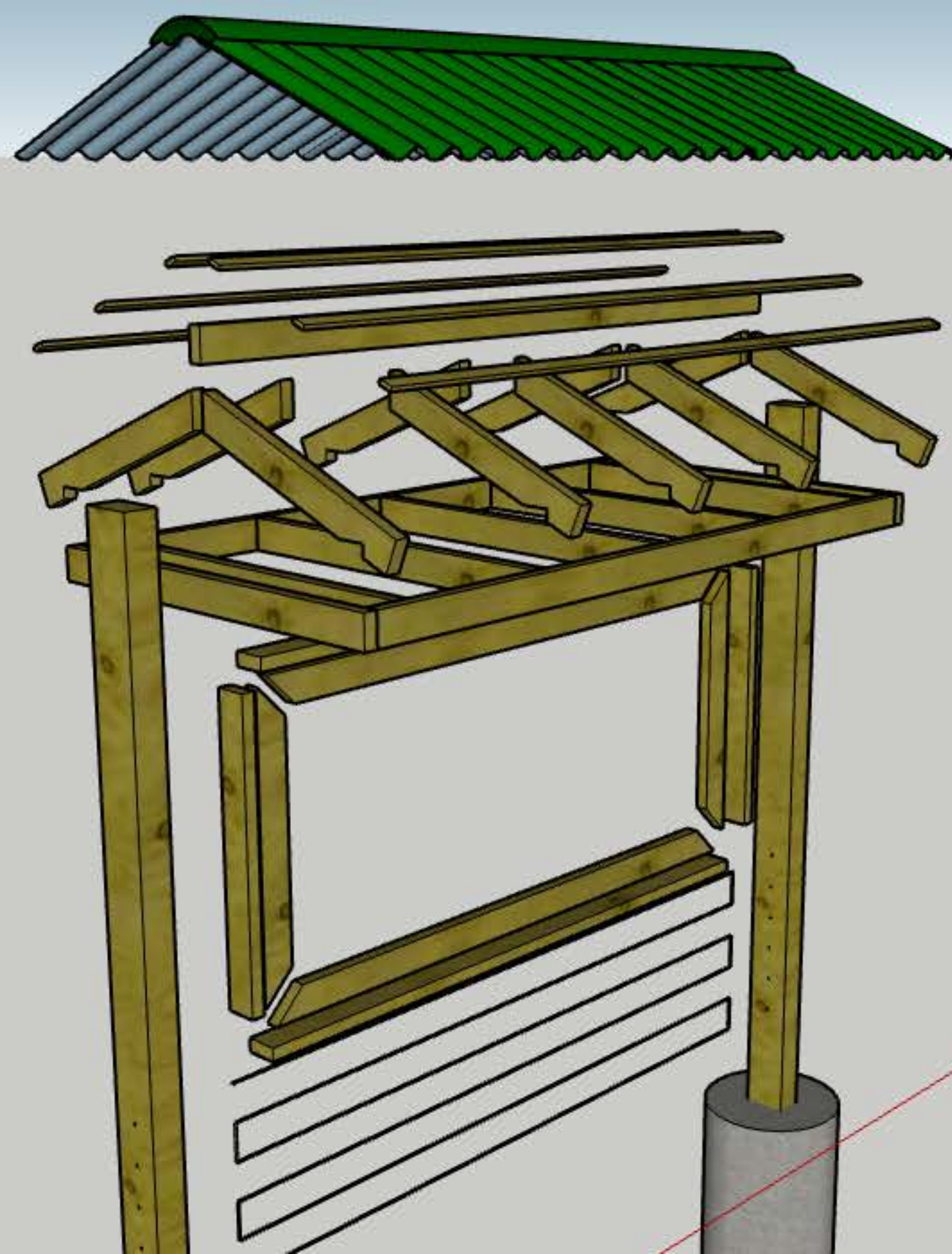

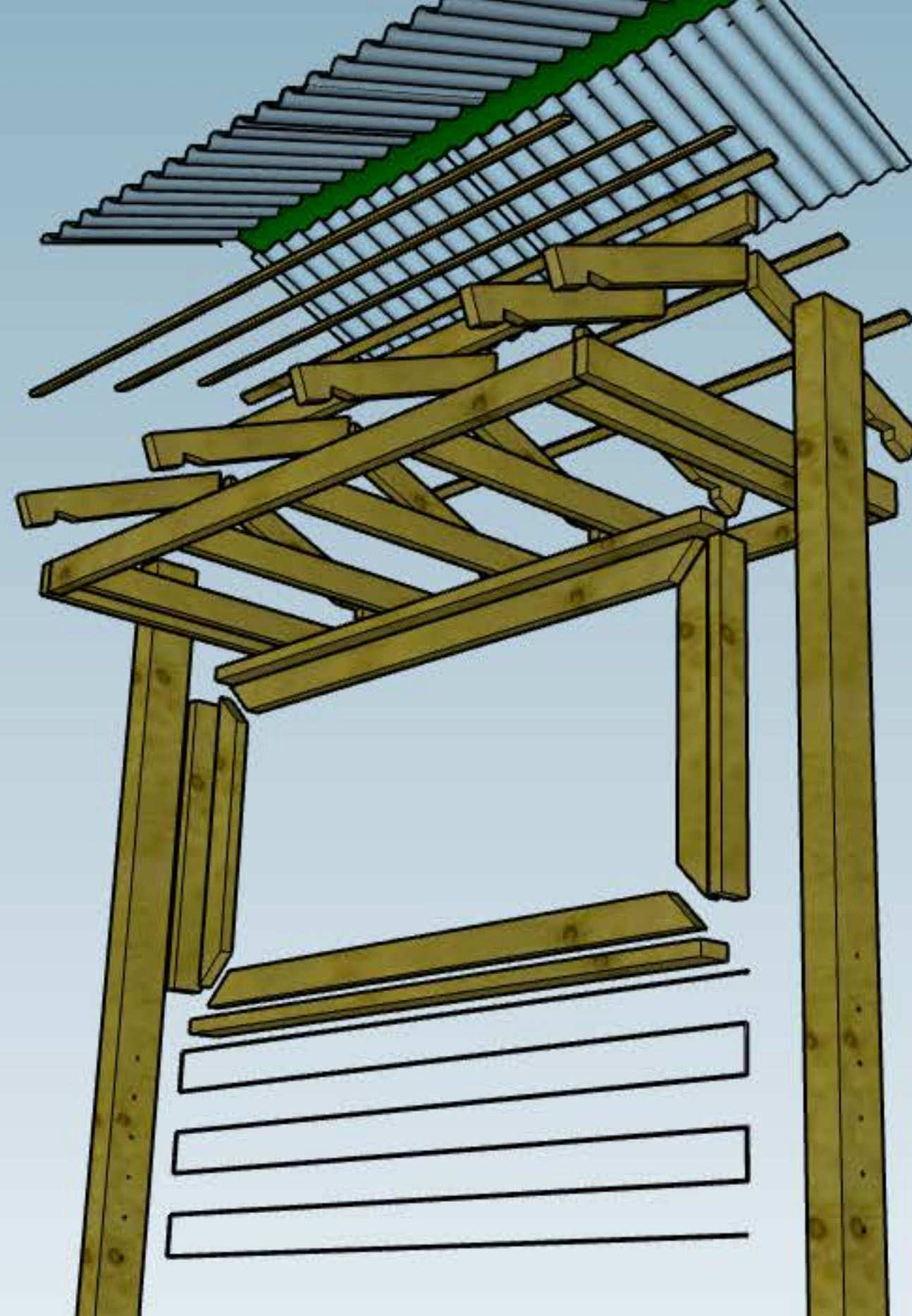

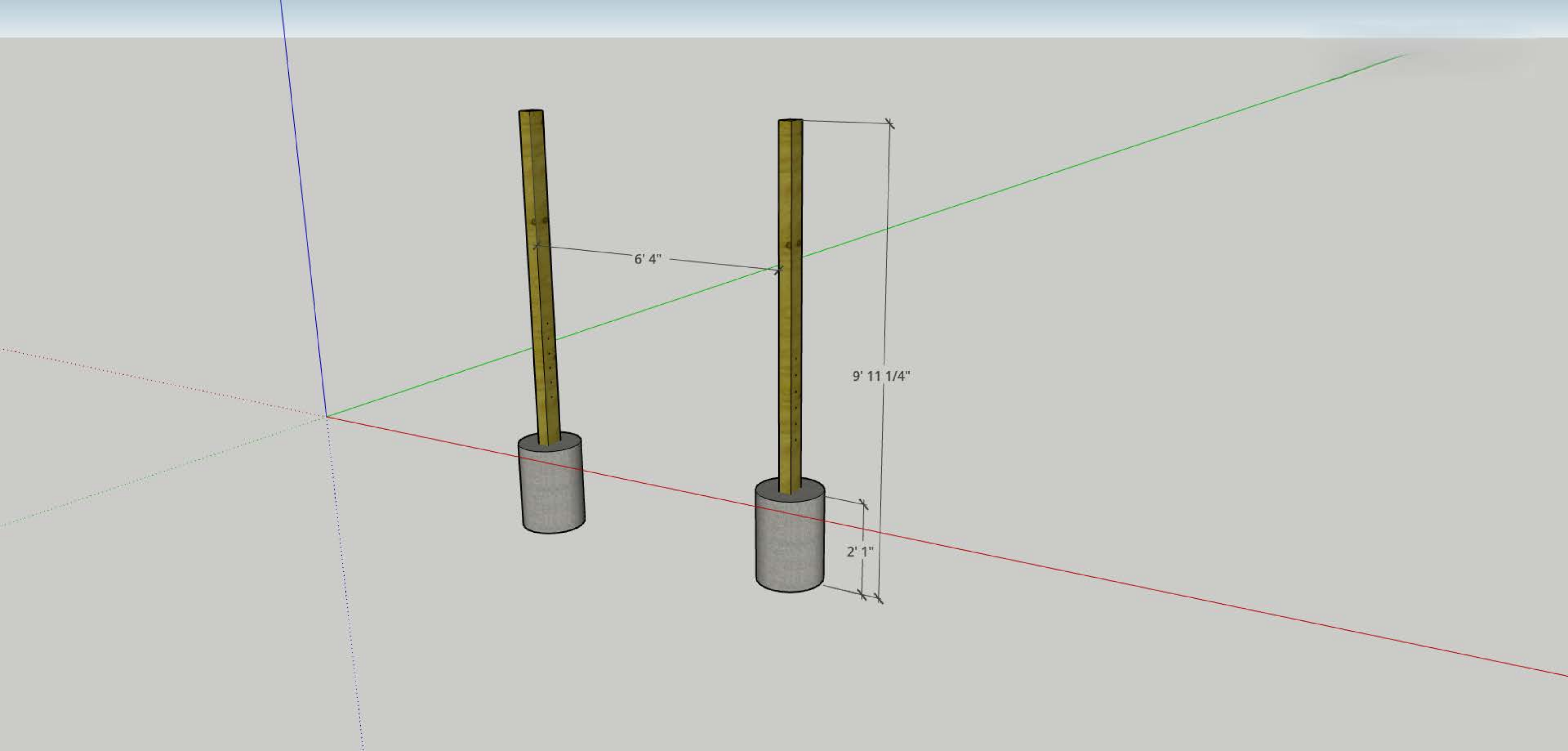

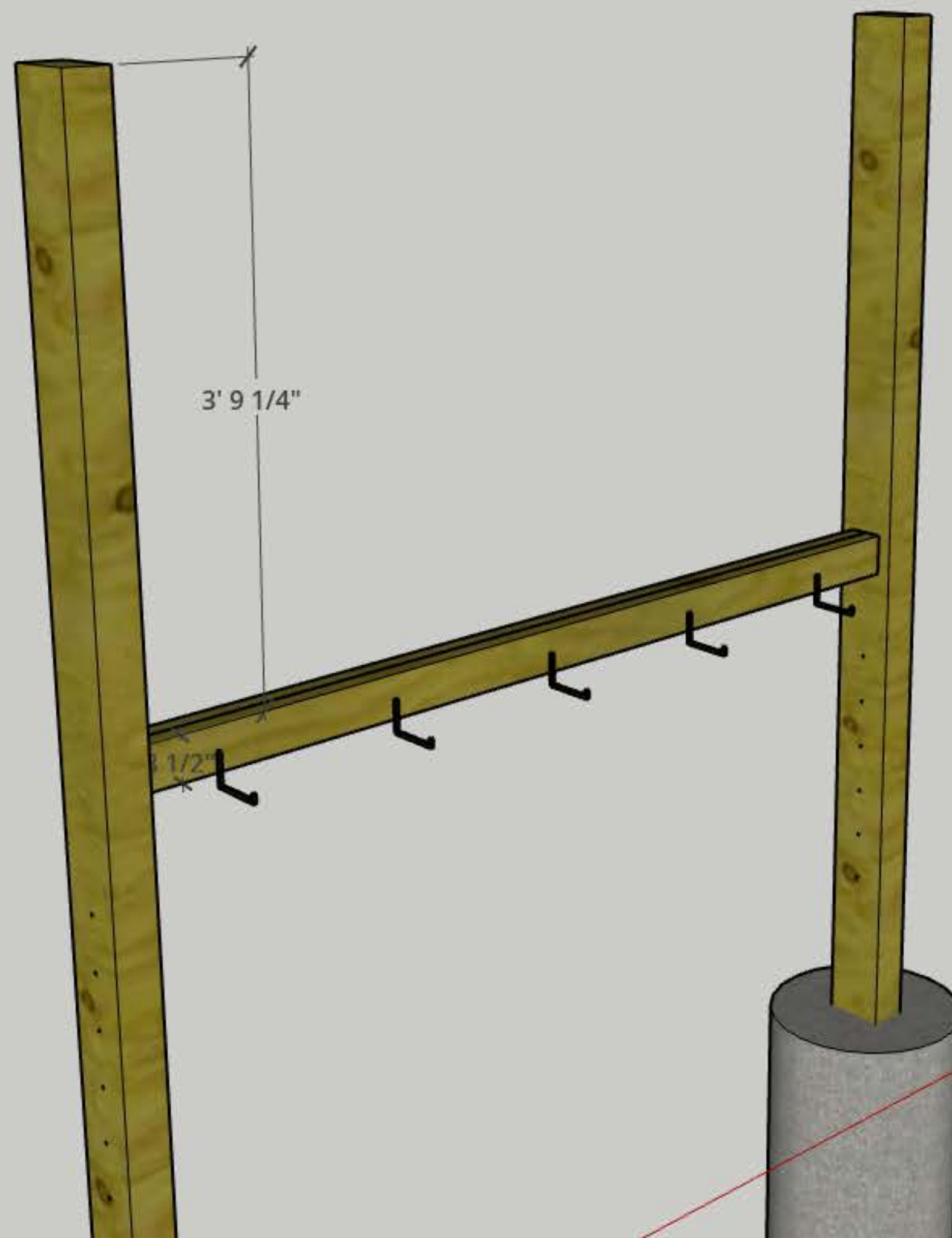

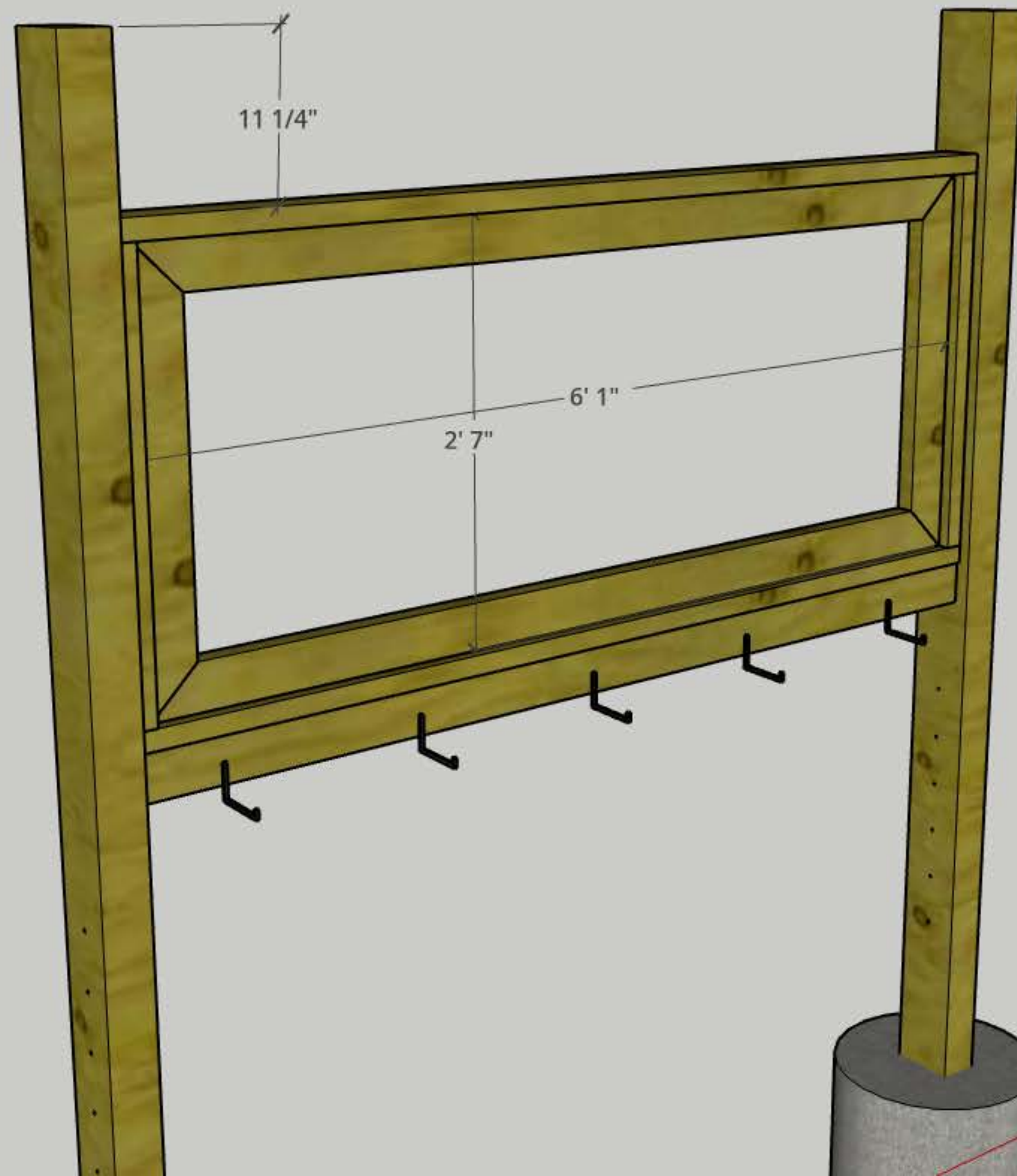

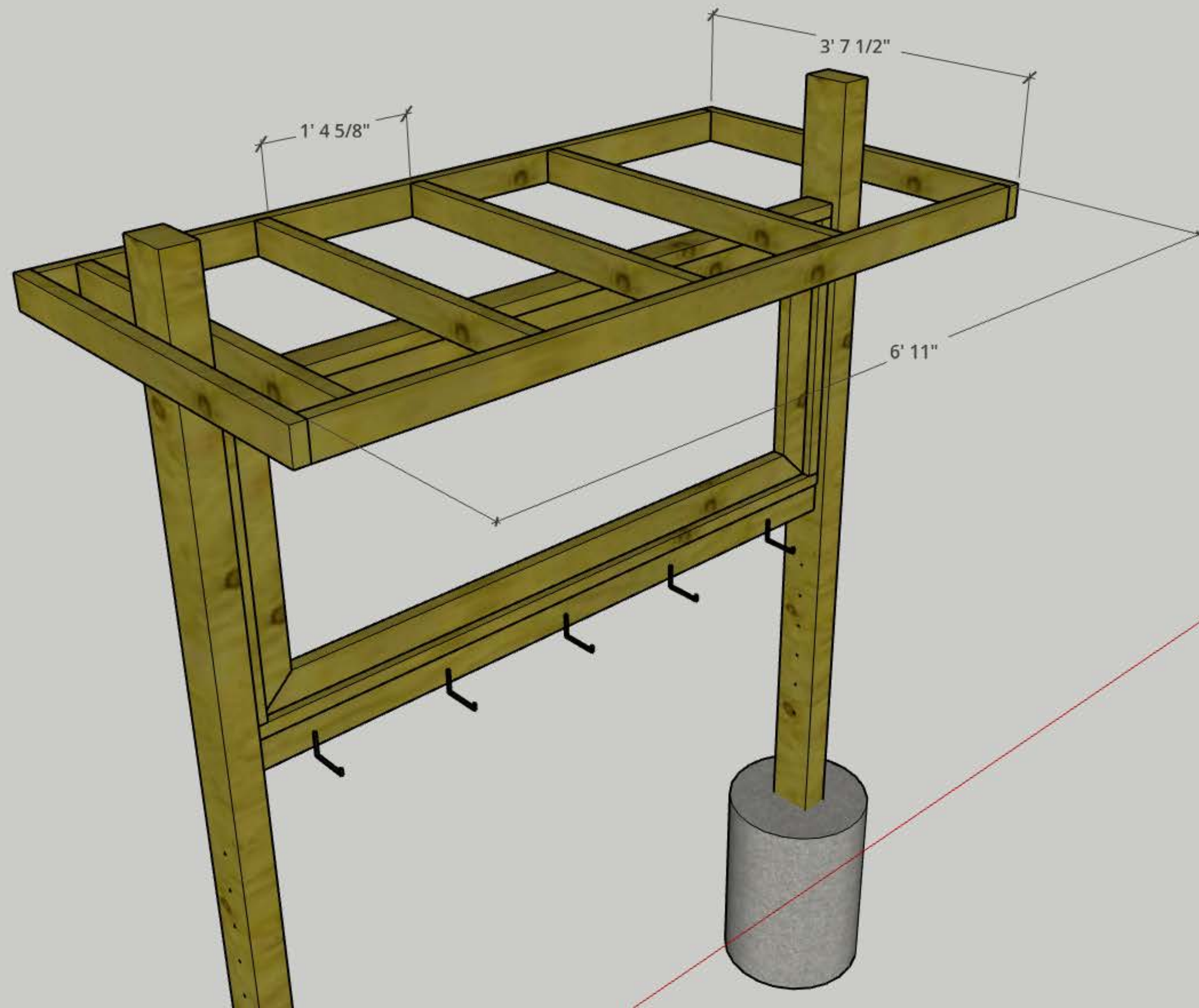

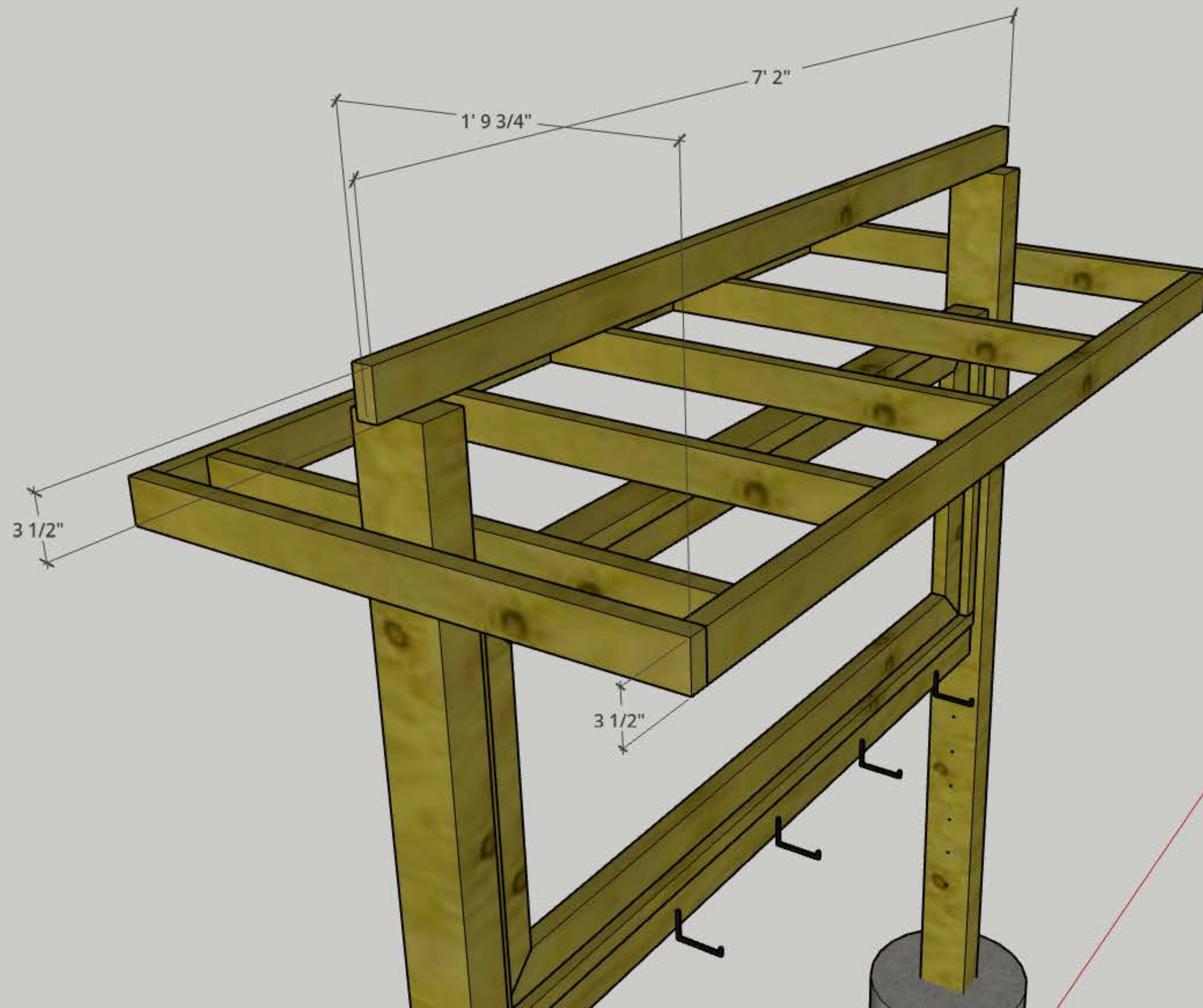

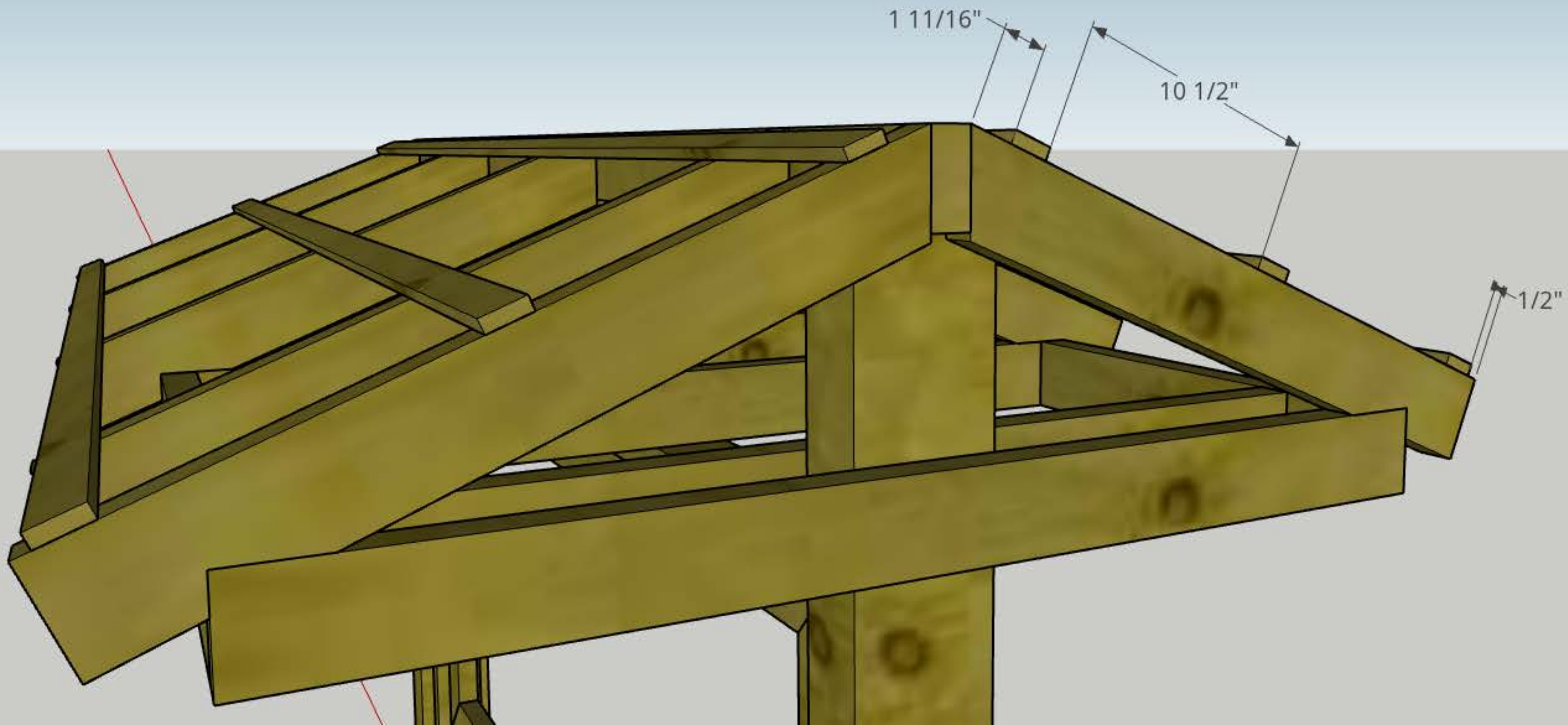

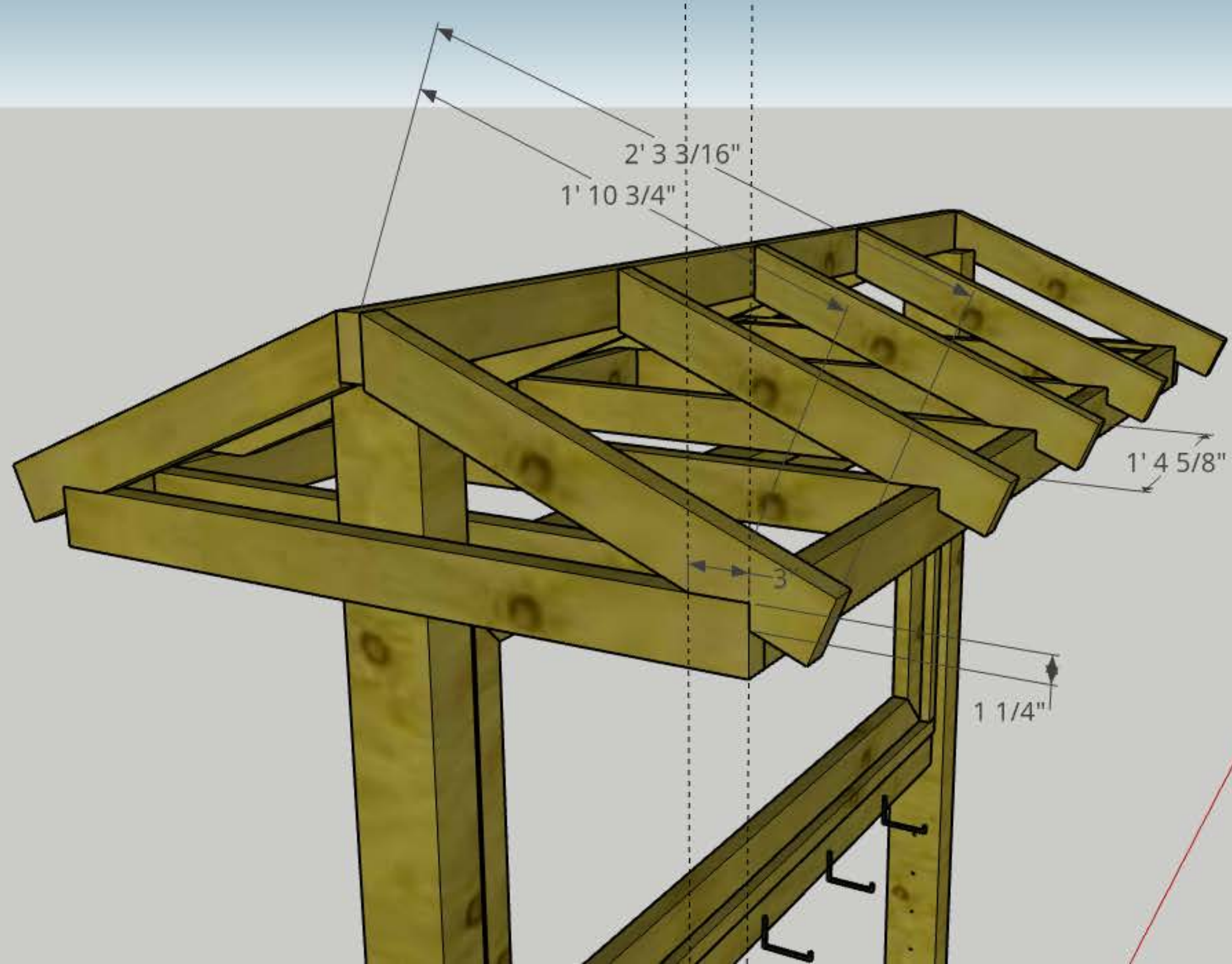

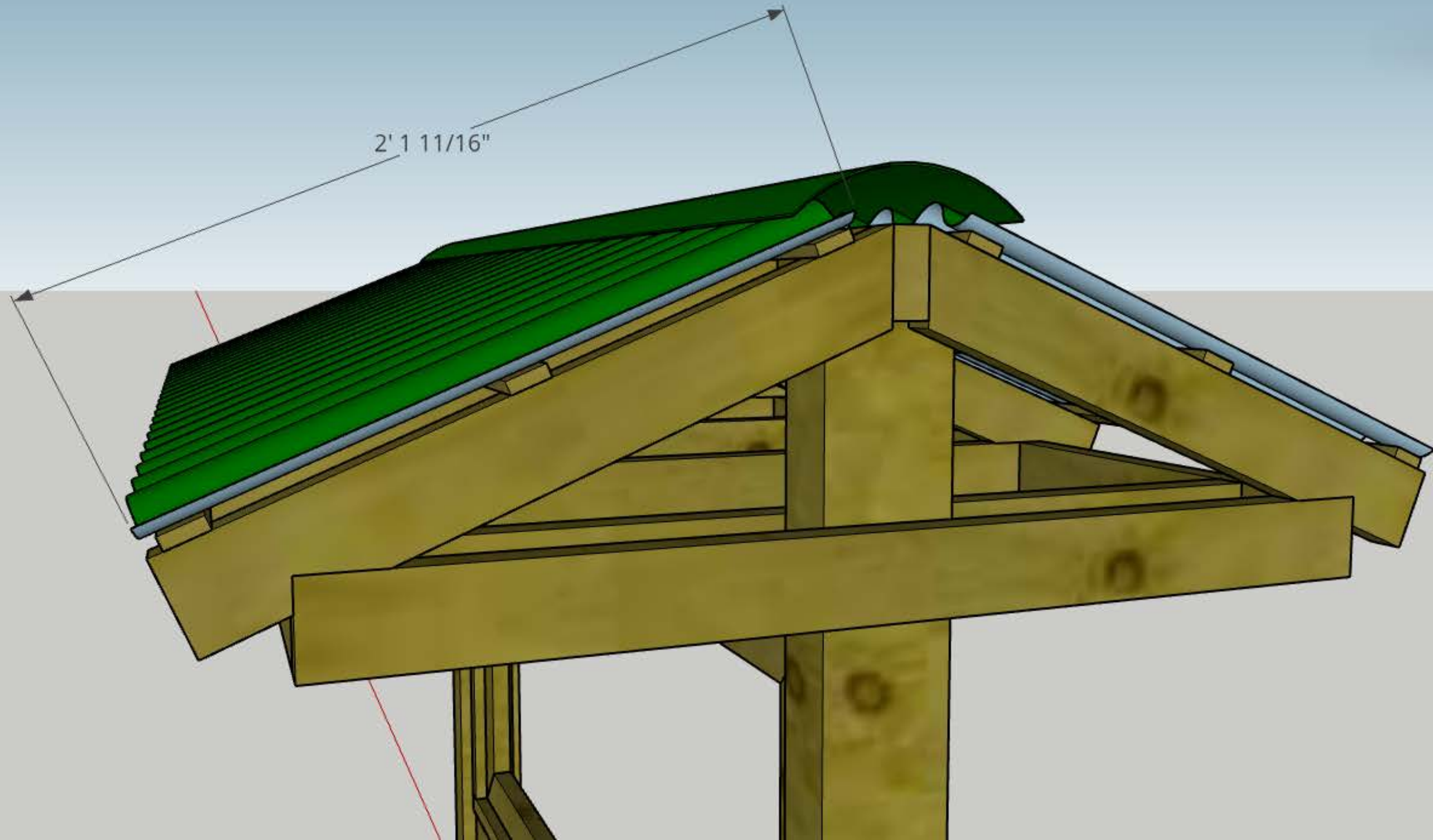



45/16"

This technical drawing shows a perspective view of a wooden frame structure. The frame consists of two vertical posts and a horizontal beam at the top. The posts are made of yellowish-brown wood and are secured to a grey cylindrical base. The horizontal beam is also made of wood and features five metal brackets attached to its underside. Five black lines, possibly representing cables or wires, are stretched between the two vertical posts. On the left vertical post, there is a small circular hole and a rectangular slot. A dimension line with arrows at both ends is positioned to the left of the post, spanning the vertical distance between the hole and the slot. The dimension is labeled '45/16"'. The background is a light blue sky and a light grey ground plane. A red line is visible in the bottom right corner of the image.